

# CLIENTELE

- Midanta Properties Pvt. Ltd
- Chungath Builders and developers
- Good number of NRI clients

# BLAZE

PROJECT MANAGEMENT CONSULTANCY



## THE PERFECT PARTNER FOR YOUR DREAM PROJECTS

Eden Plaza (Door no. VI(671)35), Seaport Airport Road, Opposite Bharat Matha College  
Thrikkakara, Kakkanad-682 021  
[www.blazepmc.com](http://www.blazepmc.com) | [joshvav@gmail.com](mailto:joshvav@gmail.com) | [joshyvarghese@blazepmc.com](mailto:joshyvarghese@blazepmc.com)



### OUR SERVICES



Detailed BOQ  
Preparation



Effective Quality &  
Safety Management



Feasibility Study



Intervention on  
Cost and Risk



Integrated Project  
Management



Quality and Safety  
Audits



Market surveys &  
Analysis



Responsible  
coordination & support  
for ISO



RERA

# WHO WE ARE...

BLAZE PROJECT MANAGEMENT CONSULTANCY is a group of experienced and committed Civil Engineers with more than two decades of experience in the construction industry in India and abroad. From feasibility studies to commissioning and beyond, we offer turnkey solutions to the construction industry. We offer a wide spectrum of services associated with construction projects. Our team has the skills and expertise to envisage and evaluate a project and to adopt the right strategy to optimize resources and complete projects within the planned budget and timeframe, thereby maximising its value. From inception through to successful completion, we offer our services ensuring technical competence, productivity, quality and diligence.

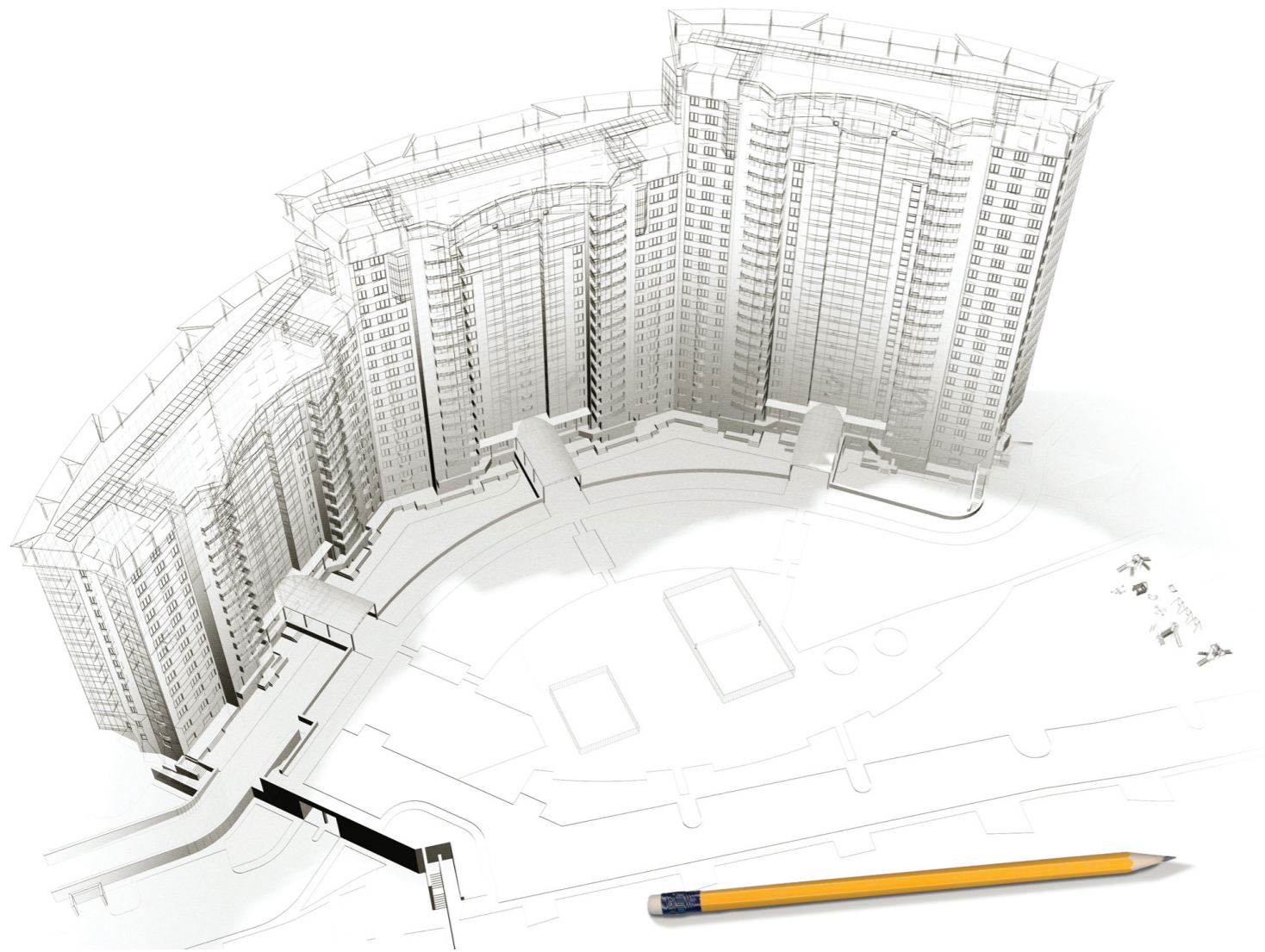

BLAZE PROJECT MANAGEMENT CONSULTANCY plays a multifaceted role in construction projects, providing necessary services through all phases. We work in sync with the targets and aspirations of the client. We are committed to ensuring cost control in every stage of the project. Through dedicated and comprehensive site management, we ensure the best outcome with highest quality and with all safety parameters fulfilled. We do risk assessments, proper analysis and scientific mitigation therein that are essential for any successful project. We provide practical and comprehensive solutions for the successful delivery of projects in line with the planned program and within the budget.

**F. Cost-effectiveness:-** Time, effort, and money spent on preventing accidents will be much less than the expenses/difficulties in dealing with accidents at a later stage.

Suitable and regular training will be imparted to the workers, including Tool Box Talks

## 5. Detailed BOQ preparation & specification finalization.

Blaze PMC focusses on the preparation of detailed Bill of Quantities, which encourages the contractors to quote competitively, given the precise quantities and specifications therein. With this professional approach, we make the entire planning, budgeting, costing and procurement process much easier and more transparent. Our team ensures that the detailed BOQ and Specifications prepared will be a clear guide to the contractor as well as the supervisory staff for quality execution of work with quality materials, standard method of work execution and professional workmanship.

## 6. Responsible coordination & support for the organizations for their ISO Certification.

Blaze PMC can assist and advise organizations effectively in getting their ISO certification through proper guidance and coordination. Getting ISO certification will be an added credential for companies of high repute.

## 7. Responsible coordination & support to the Organizations for RERA (Real Estate Regulatory Authority) approval of their prestigious projects.

Through proper coordination and guidance including documentation works, Blaze PMC can support organizations requiring RERA approval for their prestigious projects.

This will help companies to continue/complete their works unhindered and in the stipulated timeframe and at the same time, the projects will be fully transparent on the website for prospective buyers to have a clear understanding of the facilities/amenities available.

## 8. Market surveys & Analysis

Blaze PMC has a particularly good experience in Civil engineering & construction market research related to real estate. In this sector, our team will carry out market research on projects related to customer requirement & company reputation, through careful and persistent work.

## 9. Feasibility Study

On large projects, Blaze PMC will effectively carry out feasibility studies considering issues such as Planning, other legal/statutory approvals, assessment of the potential to re-use existing facilities, assessment of any site information provided by the client including geotechnical studies, and/or any other related information.



# WE OFFER...

## 1. Integrated Project Management

BLAZE PMC is a professional organization offering customized, scientific and structured solutions to meet all Project Management requirements for successful and satisfactory completion of construction projects, whether individual villas, residential/commercial buildings, mass housing complexes or warehouses etc. Working in tandem with the clients, we ensure diligent planning, execution, quality and safety management, risk analysis and management, certification of bills, assisting in selection of appropriate contractors, vendors and material suppliers, etc. thereby helping to complete a successful project within the stipulated timeframe and budget..

## 2. Quality and Safety Audits

Effective Quality and Safety audits based on BSI standards and the Organizational standards will be implemented with inspections at site on a regular basis at critical stages of execution. Initial and final snag lists are prepared for error-free handing over of projects within the stipulated time and budget.

## 3. Intervention on Cost and Risk management.

BLAZE PMC offers a comprehensive framework designed to safeguard the project at every stage of design, procurement and construction execution through to successful handing over. Working hands-on with the client, we help to minimize errors/delays throughout the construction stage until handover. Our working strategy includes arriving at a proper budget and then managing the project within this constraint. Any additions/alterations to the existing work and/or extra works will be brought to the attention of the Client along with the costs involved, if any, and taken up only after his/her concurrence.

## 4. Effective Quality & Safety Management System implementation.

A good Quality & safety management system can go a long way in creating and delivering quality projects without accidents and occupational hazards. BLAZE PMC's effective QSMS goes beyond a prescriptive, "Do this, don't do that" approach to building construction.

We insist upon the construction organizations of high repute to have an effective Quality & Safety Management System, which will be in line with the rules and regulations applicable in that area, and also not put its employees at risk. This will also reduce any additional costs in dealing with accident cases later on for the following reasons:

- A. Balance in cost & time:-** As a preventive action to keep an appropriate level of quality determined during phases of construction without compromising on cost and time.
- B. Continual Improvement:-** A defined system continually improves the communication, Efficiency, Working practices, control over projects, culture, participation of the employees , customer satisfaction and in turn total growth of the organization.
- C. Easy compliance with rules and regulations:-** An organization which runs systematically adhering to the norms and regulations, will find it easy to comply with standard certifications and approvals from the government and concerned authorities.
- D. Moral obligation:-** No company should place its employees, or people associated with it whether directly or otherwise, at risk.
- E. Regulations:-** At present it is a legal responsibility for organisations to promote and maintain secure working conditions.

# VISION...

To ensure the entire satisfaction of our clients in realizing their dream of a high quality, safe and legally compliant housing/building thereby contributing to a green and dispute-free environment in the construction industry and a sustainable growth of economy.

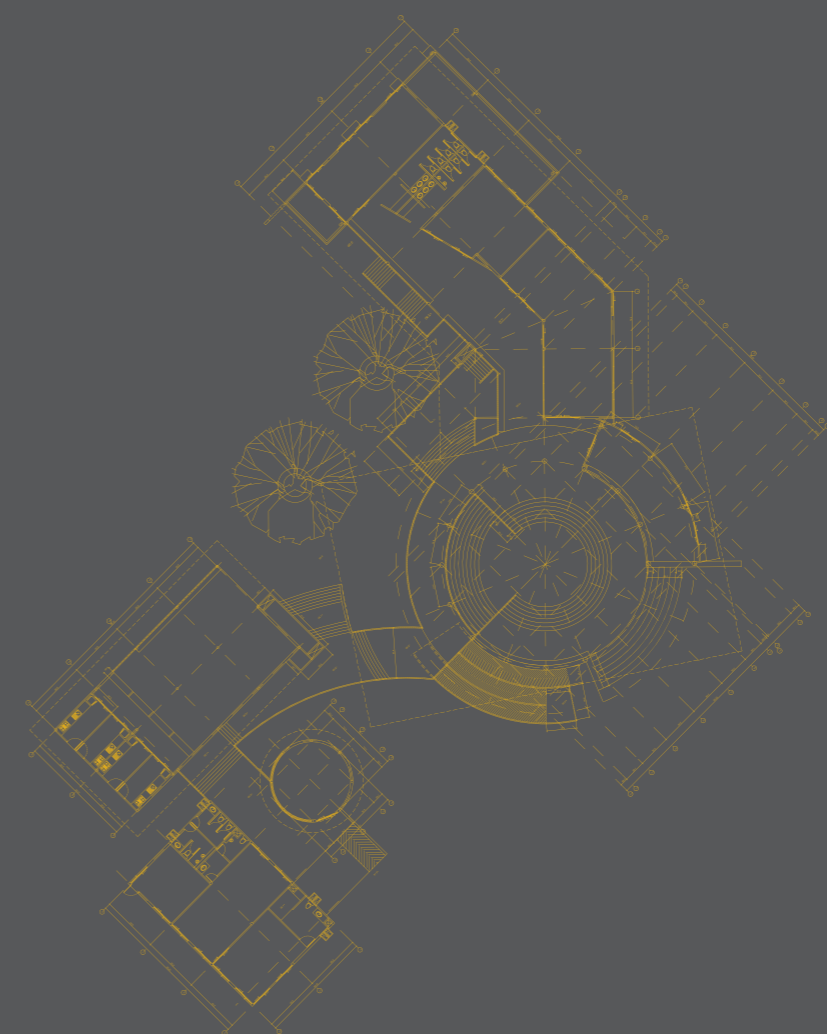

# MISSION...

To be a prompt service provider in the construction industry with dignity, identifying the dreams of all our clients by working to the highest degree of quality standards, imparting a procedure of strict quality practices, efficient control measures on cost, optimization of specifications, diligent documentation process, upholding adherence to safety practices, so as to focus on the total satisfaction of our clients.

## WHAT WE DO...

As we have noticed, quite a number of construction projects have been found stopped midway, some in the beginning stage itself. When the client/owner undertakes to plan and construct his/her dream project on his/her own, he /she is bound to get stuck midway as he/she is unaware of the industry norms and/or the complex procedures involved therein .In this scenario, our team plays a vital role in assessing the hurdles and bottlenecks for the client at every stage of planning and execution through to completion, leaving his/her precious time unaffected and his/her dream come true.

The professional approach of the BLAZE Project Management Consultancy team ensures smooth running of any project that it undertakes. We manage these projects by applying practical knowledge, skills, technical expertise, finance management expertise and construction experience at all stages. Our team is dedicated to ensuring timely completion of the projects while maintaining high quality standards. We efficiently tackle the challenges in handling and coordinating every aspect in project execution, like viability, structural design, availability of quality materials, contractor finalization/co-ordination, engineering, safety requirements and beyond.

We assure our clients well constructed projects on time with high quality standards through the coordination of nominated contractors/sub-contractors across all phases of the project. We deal with not only Civil, but Architectural/Structural/MEP/Soft & Hard Landscaping and all other allied works.

We provide dedicated consultancy services to all our clients including the preparation of regular progress reports, in-process inspections of works, material testing as per standard requirements, updating of project documents, coordination with the client & contractors, site safety system & standard practices implementation and progress monitoring. A detailed audit report on quality and progress will be shared every month to the client with regard to the improvements at site.

## OUR CORE STRENGTH...

- More than two decades of professional experience in the construction industry.
- Dedicated team of seasoned Civil Engineers and Project Management Consultants.
- All round expertise in project consulting and site management.
- Detailed study of Time-Cost-Risk-Scope-Quality & Resource Management
- Help identify the best fit contractors/ vendors / material suppliers.
- Comprehensive site supervision, ensuring quality and transparency in reporting.
- Ensuring all the snags get rectified by the contractors, prior to handover.
- Strictly adhering to the Indian standard codes of practice, following Kerala Building Rules.
- We boast of a wholly satisfied clientele list that includes good number of NRIs



## WHAT WE ENSURE...

- Project cost reduction through efficient planning and coordination.
- Coordination among different stakeholders right from the design phase.
- Activity sequencing to reduce idle man hours in all seasons.
- Round table progress reviews, design- construction interface.
- Safe working methodologies & Safety awareness programs.
- Penalty enforcement on defaulters.
- Customised project management and technical advice to the clients.
- Ensure accuracy of payments and payment certificates.
- The client is free from day-to-day involvement in construction works.
- Review & Reporting to the clients on a regular basis.
- Project delivery as visualized by the client, both aesthetically & functionally.